

SCHORR FAMILY FIREHOUSE STAGE  
FACT SHEET

STREET ADDRESS: 46-48 Willow Street, Johnson City, NY 13790

STAGE PHONE: 607.798.0627

CONTACT PHONE: 607.772-2404

GENERAL MANAGER: Christine Springer 607.772-2404, ext. 307

OPERATIONS MANAGER: Bill Nurse 607.772-2404, ext. 308

ADMINISTRATIVE OFFICES: 67 Broad Street, Suite 210, Johnson City, NY 13790

SEATING CAPACITY: Up to 175 CONFIGURATION: Varies

STAGE: 24' x 16' x 24" (twelve 4' x 8' i. weiss Stage 500 black painted platforms with 24 inch legs)

CEILING HEIGHT:

12' 8" floor to ceiling	9' 8" stage to ceiling
11' 7" floor to high beam	9' 7" stage to high beam
11' 2" floor to low beam	9' 2" stage to low beam

This is a non-traditional, flexible performance space that can be set theater style or cabaret style. There is no permanent masking or stage curtain.

ELECTRIC:

Several 20 Amp circuits are available in the stage area  
Special power requirements can be handled with prior arrangements

DIGITAL PROJECTOR: Dell 2400MP 3000 Lumen Projector

DRESSING ROOMS: (located SR)

- (1) 6-8 person Chorus Room with toilet, sink, shower, and refrigerator
- (1) 6-8 person Chorus Room with sink and refrigerator
- (1) Wheelchair accessible small dressing room with toilet and sink

LOAD IN:

Street level through 72" x 96" front doors. Level to stage and dressing room areas. No ramp onto stage platforms. All dressing rooms have 34" x 78" opening with doors fully open.  
One step up through 28" x 78" stage door on North side of building.

## LIGHTING:

- (1) ETC Smartfade 2496 Lighting Control Board (24 channels in 2 scene mode; 96 channels in normal mode)
- (2) ETC SB6-10 SmartBar2 Dimmers (6 10A Dimmers) w/ 2P&G
- (8) ETC PAR EA Lighting Fixtures with 2P&G Connectors
- (2) Source 4 JR 25-50 Zoom 2P&G Male Connectors w/drop in iris
- (4) Altman Zipstrip strip lights 6'4" long. Each has 3 circuits, 5 cells per circuit, 2-50W lamps per cell. Each circuit in each strip is individually controlled. These are normally mounted as top cyc lights but can be moved by special arrangement.
- \* Various lengths of 2P&G and edison/U ground cable.
- \* Stage work lights independent of stage lighting.

## SOUND:

- (2) QSC HPR 122 Powered Speakers on stage wall mounts
  - (1) Peavey 112PM Powered Monitor
  - (1) Allen and Heath MixWizard WZ3 16:2 (with talk back in Ch 16)
  - (1) 16 in, 4 out snake that will reach any area on stage. All XLR connectors.
  - (2) Gemini CDJ-01 CD players
  - (2) Sennheiser E1000 Hand Held Wireless Microphones
  - (5) Sennheiser E835 Hand Held Wired Microphones
  - (1) Sennheiser Lavalier Microphone
  - (1) Shure SM58 Microphone
  - (1) Shure SM57 Microphone
  - (1) AKG D112 Microphone
  - (2) audio-technica AT813 Microphones
  - (5) 3 leg Microphone Stands with boom
  - (2) 3 leg Microphone Stands
  - (2) round base short Microphone Stands
  - (5) round base Microphone Stands with boom
  - (1) round base Microphone Stand
- XLR Cables
- 2 – 10'
  - 9 – 25'
  - 2 – 30'
  - 2 – 50'

# Firehouse Stage Performance Area

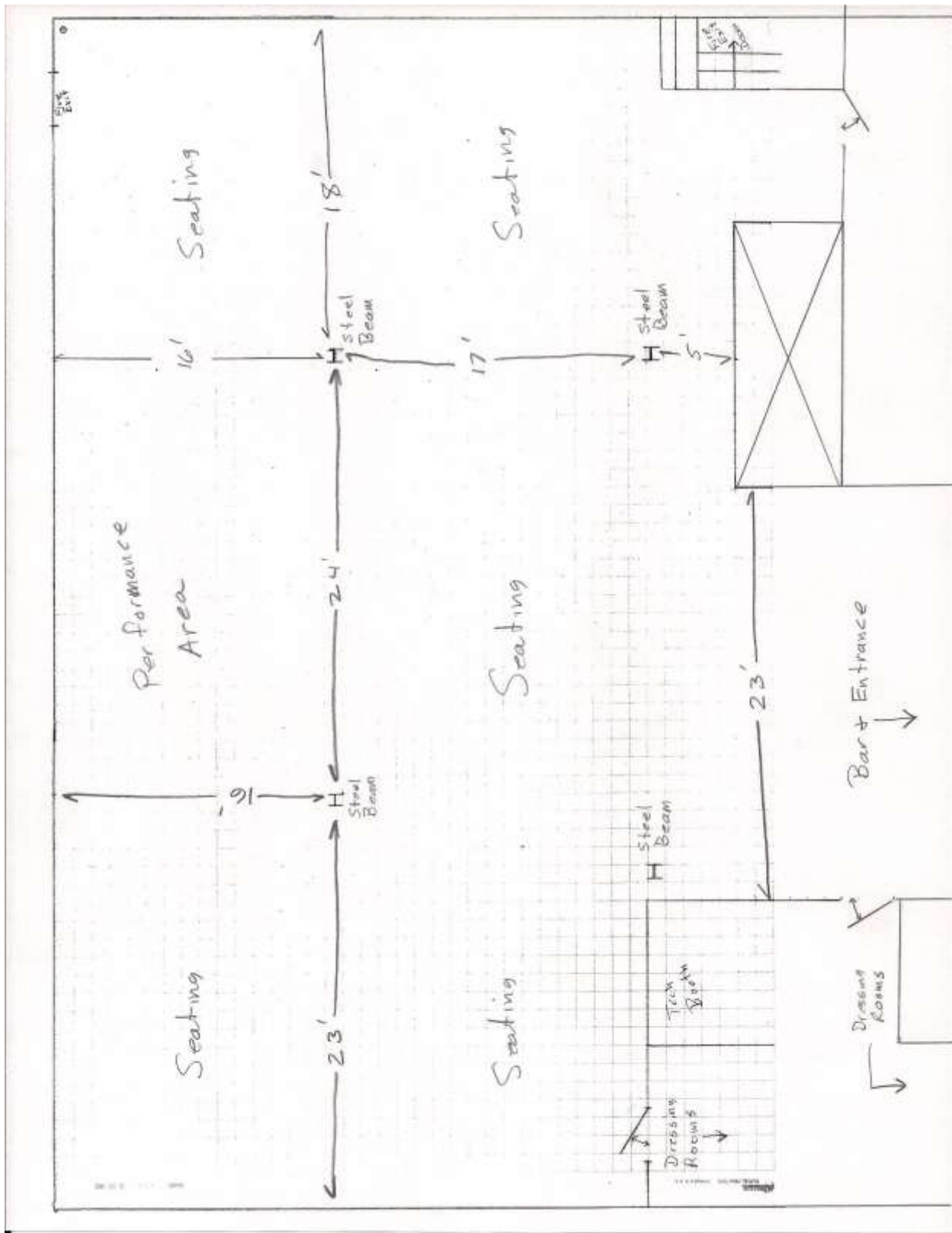

View from bar / entrance area to performance area. White background is 24 feet wide.



View from up stage right of performance area to bar / entrance and tech booth and dressing room hall doors.

